

Active
R2523193
 Board: V
 Apartment/Condo

913 8688 HAZELBRIDGE WAY

Richmond
 West Cambie
 V6X 0R6

Residential Attached
\$998,000 (LP)
 (SP) 

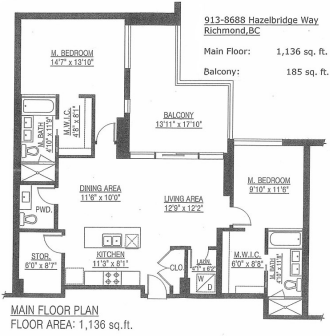

Sold Date:
 Meas. Type:
 Depth / Size (ft.):
 Lot Area (sq.ft.): **0.00**
 Flood Plain:
 Council Apprv?:
 Exposure: **South**
 If new, GST/HST inc?: **No**
 Mgmt. Co's Name: **Associa**
 Mgmt. Co's Phone: **604-591-6060**
 View: **Yes: Courtyard**
 Complex / Subdiv: **SORRENTO - CENTRAL**
 Services Connected: **Electricity, Natural Gas, Water**

Frontage (feet):
 Frontage (metres):
 Bedrooms: **2**
 Bathrooms: **3**
 Full Baths: **2**
 Half Baths: **1**
 Maint. Fee: **\$391.00**

Original Price: **\$998,000**
 Approx. Year Built: **2018**
 Age: **2**
 Zoning: **CONDO**
 Gross Taxes: **\$3,101.23**
 For Tax Year: **2020**
 Tax Inc. Utilities?:
 P.I.D.: **030-530-199**
 Tour: **Virtual Tour URL**

Style of Home: **5 Plus Level, Inside Unit**
 Construction: **Concrete**
 Exterior: **Concrete, Glass, Other**
 Foundation: **Concrete Perimeter**
 Rain Screen:
 Renovations:
 Water Supply: **City/Municipal**
 Fireplace Fuel:
 Fuel/Heating: **Forced Air, Heat Pump**
 Outdoor Area: **Balcony(s)**
 Type of Roof: **Other**

Reno. Year:
 R.I. Plumbing: **No**
 R.I. Fireplaces:
 # of Fireplaces: **0**

Total Parking: **1** Covered Parking: **1** Parking Access:
 Parking: **Garage Underbuilding**
 Locker:
 Dist. to Public Transit:
 Units in Development:
 Title to Land: **Freehold Strata**
 Property Disc.: **No**
 Fixtures Leased: **No**
 Fixtures Rmvd: **No**
 Floor Finish: **Laminate, Mixed**

Maint Fee Inc: **Caretaker, Garbage Pickup, Gardening, Gas, Hot Water**
 Legal: **STRATA LOT 222, BLOCK 5N, PLAN EPS5073, SECTION 28, RANGE 6W, NEW WESTMINSTER LAND DISTRICT, TOGETHER WITH AN INTEREST IN THE COMMON PROPERTY IN PROPORTION TO THE UNIT ENTITLEMENT OF THE STRATA LOT AS SHOWN ON FORM V**

Amenities: **Air Cond./Central, Club House, Pool; Indoor, Sauna/Steam Room, Swirlpool/Hot Tub**

Site Influences: **Central Location, Shopping Nearby**
 Features: **ClthWsh/Dryr/Frdg/Stve/DW, Drapes/Window Coverings, Microwave, Oven - Built In**

Floor	Type	Dimensions	Floor	Type	Dimensions	Floor	Type	Dimensions
Main	Living Room	12'9 x 12'2			x			x
Main	Dining Room	11'6 x 10'0			x			x
Main	Master Bedroom	14'7 x 13'10			x			x
Main	Master Bedroom	11'6 x 9'10			x			x
Main	Kitchen	11'3 x 8'1			x			x
Main	Den	8'7 x 6'0			x			x
Main	Walk-In Closet	8'8 x 6'0			x			x
Main	Walk-In Closet	8'1 x 4'8			x			x
					x			
					x			

Finished Floor (Main):	1,136	# of Rooms: 8	# of Kitchens: 1	# of Levels: 1	Bath	Floor	# of Pieces	Ensuite?	Outbuildings
Finished Floor (Above):	0	Crawl/Bsmt. Height:			1	Main	5	Yes	Barn:
Finished Floor (Below):	0	Restricted Age:			2	Main	5	Yes	Workshop/Shed:
Finished Floor (Basement):	0	# of Pets:	Cats:	Dogs:	3	Main	2	No	Pool:
Finished Floor (Total):	1,136 sq. ft.	# or % of Rentals Allowed:			4				Garage Sz:
Unfinished Floor:	0	Bylaws: Pets Allowed, Rentals Allowed			5				Door Height:
Grand Total:	1,136 sq. ft.	Basement: None			6				
					7				
					8				

Listing Broker(s): **Anson Realty Ltd.**

All here! Sorrento at Richmond with the best of "resort" style living, centrally located, minutes walking from shopping, fine dining and future Canada Line Station - Capstan Village. This brand new unit features 9' ceilings, central air conditioning, 2 ensuite, huge balcony looking at the attractive courtyard. Move in today!